

Mono Desk in Solid Surface

With a refined aesthetic, the modular elements of the award-winning **Mono** reception desk can be configured to make virtually any layout solution achievable. Highly flexible to suit individual project requirements, the desks in solid surface have a seamless, highly durable, impact-resistant finish, making them ideal for hardworking office, reception and public spaces.

Key features

Modular on specification, seamless on installation

Easy to specify modular components

Three height options of 30", 37.5" and 43.25" as standard

DDA modules available

Translucent branding, LED skirting, sign-in platform and storage units available as options

Reception desks can be handed to the left or right

Cable management included as standard

Various colour options available

Available in 6-8 weeks (UK), 10-12 weeks (US)



**Mono Desk in Solid Surface
Modules**

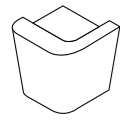

MD01
Left End
W32.5
D34.5
H30/37.5/43.5"

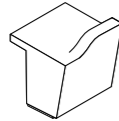

MD02
Left Scoop
W31.5
D34.5
H37.5/43.5"

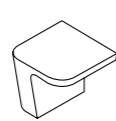

MD03
Left End DDA
W31.5
D33.5
H30"

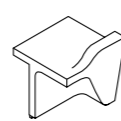

MD04
Left DDA
W31.5
D34.5

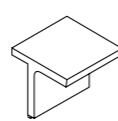

MD05
Straight DDA
W31.5
D33.5
H30"

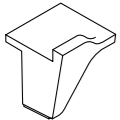

MD06
Right DDA
W31.5
D34.5
H30/37.5/43.5"

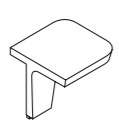

MD07
Right End DDA
W31.5
D33.5
H30"

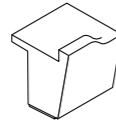

MD08
Right Scoop
W31.5
D34.5
H37.5/43.5"

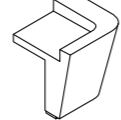

MD09
Right End
W32.5
D34.5
H30/37.5/43.5"

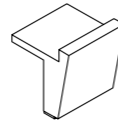

MD10
Straight
W31.5
D34.5
H30/37.5/43.5"

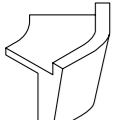

MD11
Angle 45
W50
D43.5
H30/37.5/43.5"

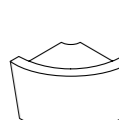

MD12
Angle 90
W54.25
D34.5
H30/37.5/43.5"

Above drawings are based on 37.5" height

Dimensions relate to the footprint of the product at:
30" height = no upstand
37.5" height = 7.5" upstand
43.5" height = 13.5" upstand

Accessories

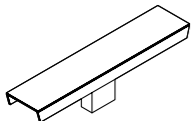

SP
Sign-in platform
Translucent smoked glass
W56.5
D12
H13.75"



TB
Translucent branding
W31.5
H8"
(recommended dimensions)



LS
LED skirting



DU
Drawer unit
W15.75
D10/20.5
H27.5"



BBF
Drawer unit
W16
D19
H27.5"

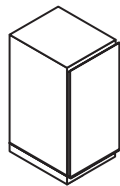

CU
Cupboard unit
W15.75
D10/20.5
H27.5"



BU
Trash bin unit
W16
D19
H27.5"



PU
Printer unit
W16
D19
H27.5"

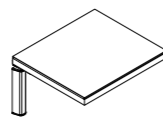

Electric sit-stand desk
H25.5-37.5"
D23.5-118"

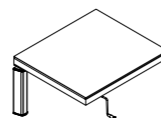

Manual sit-stand desk
H25.5-37.5"
D23.5-118"

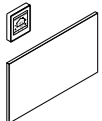

Infrared heating panel

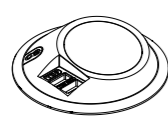

Surface Power



Mono Desk in Solid Surface Configurations



Configuration 1

W65
D34.5
H30/37.5/43.5"



Configuration 2

W96.5
D34.5
H30/37.5/43.5"



Configuration 3

W95.5
D34.5
H30/37.5/43.5"



Configuration 4

W127
D34.5
H30/37.5/43.5"



Configuration 5

W222.5
D34.5
H30/37.5/43.5"

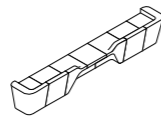

Configuration 6

W98/63.75
D34.5
H30/37.5/43.5"



Configuration 7

W151/84.5
D34.5
H30/37.5/43.5"

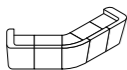

Configuration 8

W151/84.5
D34.5
H30/37.5/43.5"

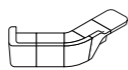

Configuration 9

W102.5/101.5
D34.5
H30/37.5/43.5"

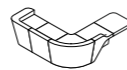

Dimensions relate to the footprint of the product at:
30" height = no upstand
37.5" height = 7.5" upstand
43.5" height = 13.5" upstand

Mono Palette Curation

Solid Surface Colour Palette

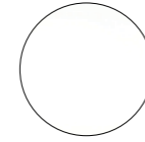

Snow
S001



Ivory
S002



Bone
S003



Cloud
S004

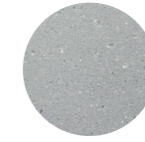

Dove
S005

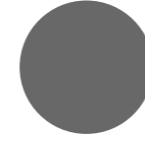

Smoke
S006



Black
S007

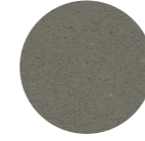

Concrete
S008



Marble
S009



Light Terrazzo
S010

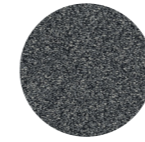

Dark Terrazzo
S011

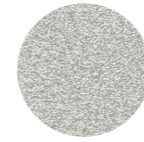

Grey Terrazzo
S012

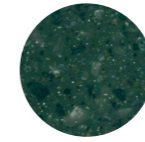

Maui
S013

Alternative colours are available on request. For a full list of colour options please download our colour chart. The printed representation of colours may vary from actual samples. Always request actual samples before ordering.