

**JD01**  
Left End  
W15<sup>3/4</sup>  
D34<sup>1/2</sup>  
H29<sup>1/2</sup> / 35<sup>1/2</sup> / 43<sup>1/2</sup>''

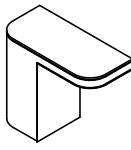

**JD02**  
Left End Scoop  
W15<sup>3/4</sup>  
D34<sup>1/2</sup>  
H29<sup>1/2</sup> / 35<sup>1/2</sup> / 43<sup>1/2</sup>''

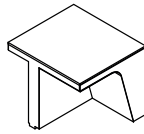

**JD03**  
Left Scoop  
W31<sup>1/2</sup>  
D34<sup>1/2</sup>  
H29<sup>1/2</sup> / 35<sup>1/2</sup> / 43<sup>1/2</sup>''

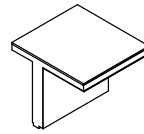

**JD04**  
Straight Scoop  
W31<sup>1/2</sup>  
D34<sup>1/2</sup>  
H29<sup>1/2</sup> / 35<sup>1/2</sup> / 43<sup>1/2</sup>''

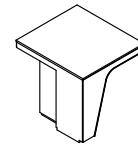

**JD05**  
Right Scoop  
W31<sup>1/2</sup>  
D34<sup>1/2</sup>  
H29<sup>1/2</sup> / 35<sup>1/2</sup> / 43<sup>1/2</sup>''

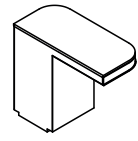

**JD06**  
Right End Scoop  
W15<sup>3/4</sup>  
D34<sup>1/2</sup>  
H29<sup>1/2</sup> / 35<sup>1/2</sup> / 43<sup>1/2</sup>''

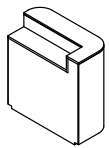

**JD07**  
Right End  
W15<sup>3/4</sup>  
D34<sup>1/2</sup>  
H29<sup>1/2</sup> / 35<sup>1/2</sup> / 43<sup>1/2</sup>''

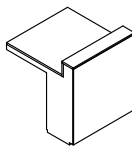

**JD08**  
Straight  
W31<sup>1/2</sup>  
D34<sup>1/2</sup>  
H29<sup>1/2</sup> / 35<sup>1/2</sup> / 43<sup>1/2</sup>''

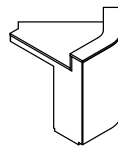

**JD09**  
Angle 45  
W789 / 945  
D34<sup>1/2</sup>  
H29<sup>1/2</sup> / 35<sup>1/2</sup> / 43<sup>1/2</sup>''

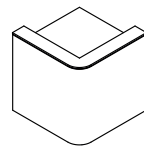

**JD10**  
Angle 90  
W875 / 875  
D34<sup>1/2</sup>  
H29<sup>1/2</sup> / 35<sup>1/2</sup> / 43<sup>1/2</sup>''

Illustrations above relate to the product at 35<sup>1/2</sup>'' height.

## Accessories

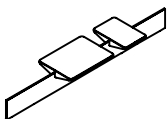

**Join**  
Sign-in platform  
Powder coated or  
hot rolled steel  
W31<sup>1/2</sup>  
D12  
H6<sup>1/2</sup>''



**RB**  
Recessed branding  
W31<sup>1/2</sup>  
H8''  
  
(recommended dimensions)

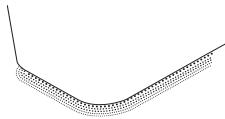

**LS**  
LED skirting

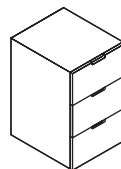

**DU**  
Drawer unit  
W15<sup>3/4</sup>  
D10 / 20<sup>3/4</sup>  
H26<sup>1/2</sup>''

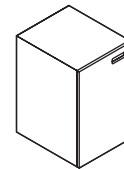

**CU**  
Cupboard unit  
W15<sup>3/4</sup>  
D10 / 20<sup>3/4</sup>  
H26<sup>1/2</sup>''

Recessed branding can be customised to any required size.

Soft close is unavailable for drawer units at 10'' depth.

# Join Desk Configurations

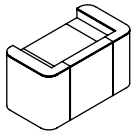

**1**  
W63  
D34<sup>1/2</sup>  
H29<sup>1/2</sup> / 35<sup>1/2</sup> / 43<sup>1/2</sup>"

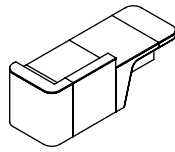

**2**  
W94<sup>1/2</sup>  
D34<sup>1/2</sup>  
H29<sup>1/2</sup> / 35<sup>1/2</sup> / 43<sup>1/2</sup>"

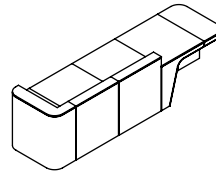

**3**  
W126  
D34<sup>1/2</sup>  
H29<sup>1/2</sup> / 35<sup>1/2</sup> / 43<sup>1/2</sup>"

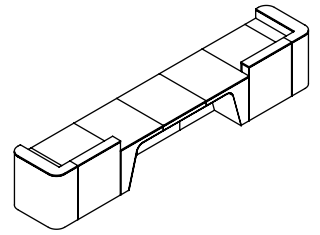

**4**  
W189  
D34<sup>1/2</sup>  
H29<sup>1/2</sup> / 35<sup>1/2</sup> / 43<sup>1/2</sup>"

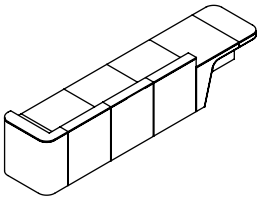

**5**  
W157<sup>1/2</sup>  
D34<sup>1/2</sup>  
H29<sup>1/2</sup> / 35<sup>1/2</sup> / 43<sup>1/2</sup>"

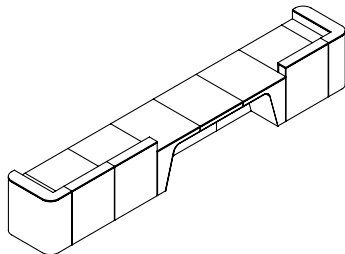

**6**  
W220<sup>1/2</sup>  
D34<sup>1/2</sup>  
H29<sup>1/2</sup> / 35<sup>1/2</sup> / 43<sup>1/2</sup>"

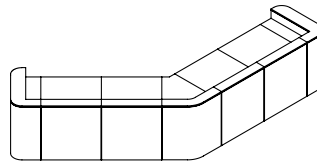

**7**  
W110 / 117<sup>1/4</sup>  
D34<sup>1/2</sup>  
H29<sup>1/2</sup> / 35<sup>1/2</sup> / 43<sup>1/2</sup>"

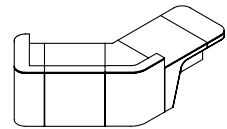

**8**  
W78<sup>1/2</sup> / 84<sup>1/2</sup>  
D34<sup>1/2</sup>  
H29<sup>1/2</sup> / 35<sup>1/2</sup> / 43<sup>1/2</sup>"

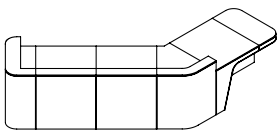

**9**  
W110 / 85<sup>3/4</sup>  
D34<sup>1/2</sup>  
H29<sup>1/2</sup> / 35<sup>1/2</sup> / 43<sup>1/2</sup>"

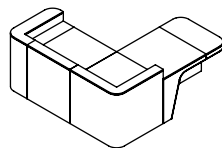

**10**  
W81<sup>3/4</sup> / 81<sup>3/4</sup>  
D34<sup>1/2</sup>  
H29<sup>1/2</sup> / 35<sup>1/2</sup> / 43<sup>1/2</sup>"

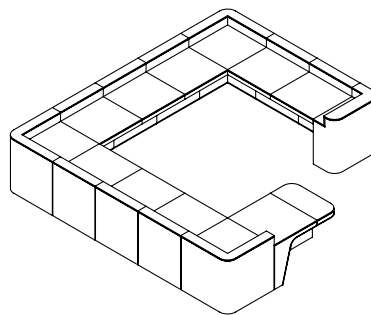

**11**  
W163<sup>1/2</sup> / 163<sup>1/2</sup>  
D34<sup>1/2</sup>  
H29<sup>1/2</sup> / 35<sup>1/2</sup> / 43<sup>1/2</sup>"

Illustrations above relate to the product at 35<sup>1/2</sup>" height.

**Website:** [www.isomi.com](http://www.isomi.com)  
**Email:** [info@isomi.com](mailto:info@isomi.com)

**North West Office:** +44 (0)161 903 9797  
**London Office:** +44 (0)20 7388 8599